

OSNOVA PRIZEMLJA

| PROSTORIJE | PODOVI | POVRSINE |
|--------------------------|---------|-----------------------------|
| ULAZ - DEG. - STEPENISTE | PARKET | 19,00 m ² |
| DN. BORAVAK-TRP. | PARKET | 45,30 m ² |
| KUHNJA | KER.PL. | 11,10 m ² |
| SPAVACA SOBA | PARKET | 8,70 m ² |
| KUPATILO | KER.PL. | 3,20 m ² |
| OSTAVA | KER.PL. | 1,00 m ² |
| TERASA | KER.PL. | 13,50 m ² |
| GARAZA | KER.PL. | 15,30 m ² |
| UKUPNO | | 117,10 m² |

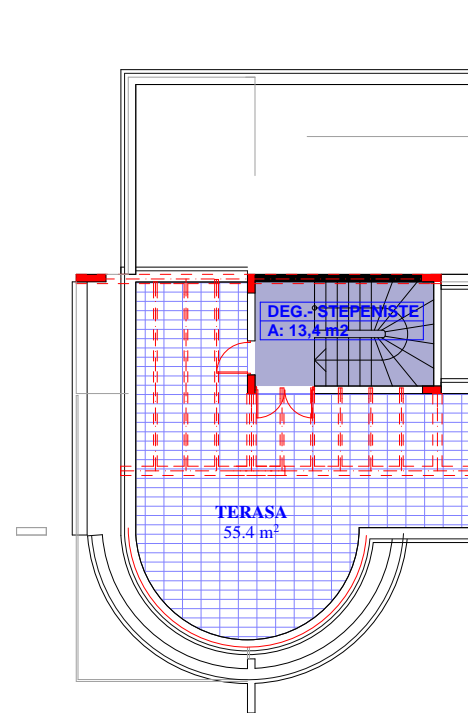

OSNOVA KROVA 1 100

| PROSTORIJE | PODOVI | POVRSINE |
|-----------------|---------|----------------------------|
| DEG.-STEPENISTE | PARKET | 13,40 m ² |
| TERASA | KER.PL. | 55,40 m ² |
| UKUPNO | | 68,80 m² |

VILA VI

PROJEKAT KOMPLEKS "VISTA" DOBRE VODE
 PROJEKTANT - ARCHI STUDIO - D.O.O. - ULCINJ